



**CTA**

Drum Diffuser

## Description

CTA drum nozzles are designed for use in wall and ceiling applications. They are intended for supply air systems.

## Properties

The nozzle construction permits warm or cool air to be thrown to long distances. The throw characteristics are suitable for constant or variable volume systems. The nozzle can be rotated 30° above and below its neutral axis, so it is possible to use with heating and cooling, by changing the nozzle throw angle. In addition, there are individually adjustable deflector blades inside the drum, to deflect air bath sideways.

## Materials

The frame and nozzle are made from ETIAL-60 norm extruded aluminium profiles.

## Surface Treatment

The surface of the diffuser is first cleaned and chromated, then painted with electrostatic powder paint to 20% gloss RAL 9010 (white) as standard. Other colours are also available upon request.

## Dimensions

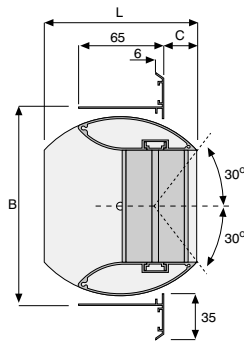
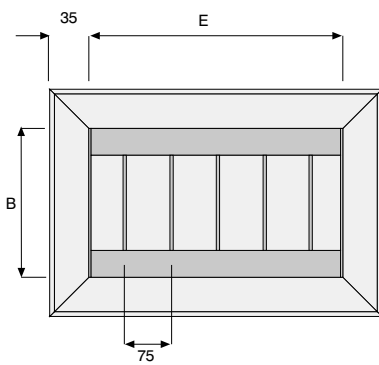

CTA.35.AA

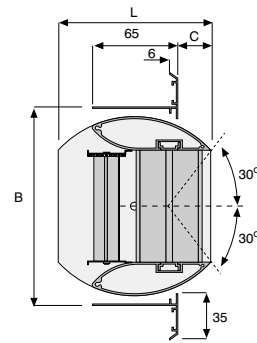

CTA.35.ZA

### Dimensions ( mm )

E	B	C	L
250	175	30	125
325	175	30	125
475	175	30	125
625	175	30	125
525	275	68	200
650	275	68	200
775	275	68	200
900	275	68	200

## Technical Data

	Size	Flow Rate (m <sup>3</sup> /h)	Isothermal Throw L (m) V <sub>L</sub> =0,25 m/s	Pressure Loss ΔP (Pa)	Sound Power Level dB (A)
TYPE - 1	250 x 175	360	5	30	22
		570	12	58	30
		780	19	90	34
		990	31	130	38
		1200	40	200	42
	325 x 175	500	8	20	22
		800	15	52	30
		1100	24	100	37
		1400	35	165	42
	475 x 175	1700	46	240	45
		680	8	20	23
		1060	17	50	32
		1440	26	80	36
		1820	40	125	41
	625 x 175	2200	50	180	45
		970	12	19	23
		1400	17	40	31
		1830	25	72	37
		2260	40	105	41
	TYPE - 2	525 x 275	2690	50	150
1500			11	30	28
2100			20	51	34
2700			30	80	38
3300			40	110	42
650 x 275		3900	50	150	45
		1900	13	30	28
		2550	20	40	34
		3200	30	62	37
		3850	40	85	41
775 x 275		4500	50	120	44
		2200	14	30	29
		3000	20	37	33
		3800	30	58	38
		4600	40	80	41
900 x 275		5400	50	115	44
		2800	14	25	29
		3650	24	38	35
		4500	34	64	39
		5350	42	80	42
		6200	50	105	45

Correction factors for different blade angles.

Blade Angle	0°	5°	10°	20°	30°	40°
Factor	1,00	0,90	0,82	0,68	0,60	0,50

Correction factors for throw angle with the horizontal

Blade Angle	0°	5°	10°	20°	30°
Factor	1,00	0,90	0,88	0,68	0,60



## Installation

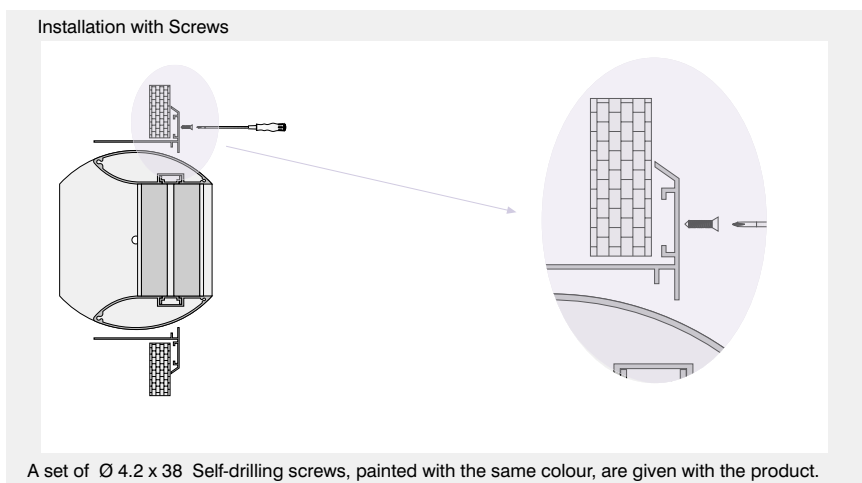

## Specification Text

Jet nozzle for wall or ceiling installation. The nozzles will be made from 1,2 thick ETIAL-60 norm extruded aluminium profile. After cleaning and chromation, the nozzles will be painted to ordered request with electrostatic powder paint and a minimum paint thickness of 60µ. There will be

individually adjustable blades within the nozzle drum, to deflect air sideways. Each nozzle will be free to rotate 60° about its axis 30° for each side of the axis.

## Order Code

<b>Model</b>	<b>CTA.35.AA.10 - 400 x 200 -9010</b>		
<b>Accessories</b>	AA ..w/o accessories ZA ..w/ Opposed Blade Damper	E x B (mm) Please refer to page 2.	Please indicate RAL colour code
<b>Installation</b>	00 ...w/o screw holes 10...with screw holes	<b>Standard dimesions</b>	<b>Colour Code</b>

C

CTA

Drum  
Diffuser

**KES KLİMA**

INDUSTRIAL AND TRADE CO.

Uzay Çağı Caddesi No:10

06370 Östim/ANKARA

Phone: +90.312.385 76 57

Fax : +90.312.354 12 31

[www.kesklima.com](http://www.kesklima.com)



TÜV Rheinland Group



DIN EN ISO 9001:2000

Zertifikat: 01 100 042854